

Ellipse Cores

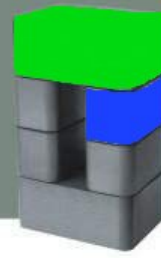

Product Identification

■ Ellipse Cores

BEC-Column

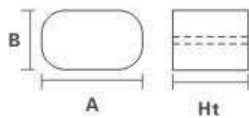

SF 35 20 L -E20 -060

Permeability: 60 μ

Height: 20mm

Ellipse Core

Width: 20mm

Length: 35mm

SF: Si-Fe S: Sendust H: High Flux

BEB-Base

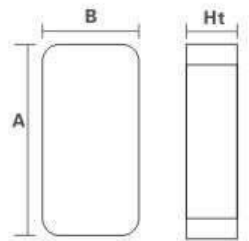

SF 50 35 L -E18 -060

Permeability: 60 μ

Height: 18mm

Ellipse Core

Width: 35mm

Length: 50mm

SF: Si-Fe S: Sendust H: High Flux

Post Part No.	Dimensions				Cross Section Area (cm ²)
	A Length (mm)	B Width (mm)	RC Radius (mm)	Ht Height (mm)	
SF3515L-E20	35	15	7.5	20	4.77
SF3515L-E25	35	15	7.5	25	4.77
SF3520L-E20	35	20	7.5	20	6.52
SF3520L-E25	35	20	7.5	25	6.52

Plate Part No.	Dimensions				Cross Section Area (cm ²)
	A Length (mm)	B Width (mm)	RC Radius (mm)	Ht Height (mm)	
SF5035L-E13	50	35	7.5	13.5	4.77
SF5035L-E18	50	35	7.5	13.5	6.52
SF6035L-E13	50	35	7.5	13.5	4.77
SF6035L-E18	50	35	7.5	13.5	6.52
SF7035L-E13	50	35	7.5	13.5	4.77
SF7035L-E18	50	35	7.5	13.5	6.52

※SF (Si-Fe), S(Sendust), H(High Flux) and customized designs are also available.

Ellipse Cores



Product Identification

■ Ellipse Cores

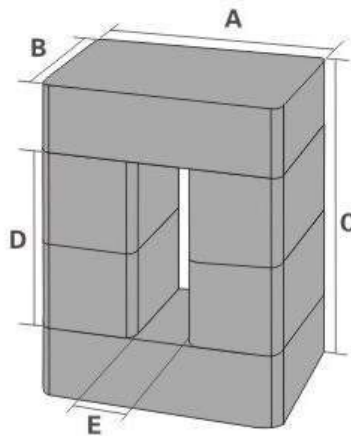

Plate Part No.	Post Part No.	1Leg Stack	Dimensions					Path Length (cm)	Cross Section Area (cm ²)	Window Area (cm ²)	A _L (nH/N ²) ± 12%		
			A Length (mm)	B Width (mm)	C Height (mm)	D Inner Height (mm)	E Inner Length (mm)				026 μ	040 μ	060 μ
SF5035L-E13	SF3515L-E20	2	50	35	67	40	20	16.47	4.77	8	113	146	218
	SF3515L-E25	2	50	35	77	50	20	18.47	4.77	10	101	130	195
	SF3515L-E20	3	50	35	87	60	20	16.04	4.77	12	91	117	176
SF5035L-E18	SF3520L-E20	2	50	35	77	40	10	18.04	6.52	4	158	204	306
	SF3520L-E25	2	50	35	87	50	10	20.04	6.52	5	141	182	273
	SF3520L-E20	3	50	35	97	60	10	22.04	6.52	6	127	164	245
SF6035L-E13	SF3515L-E20	2	60	35	67	40	30	18.47	4.77	12	101	130	195
	SF3515L-E25	2	60	35	77	50	30	20.47	4.77	15	91	117	176
	SF3515L-E20	3	60	35	87	60	30	22.47	4.77	18	83	107	160
SF6035L-E18	SF3520L-E20	2	60	35	77	40	20	18.04	6.52	8	141	182	273
	SF3520L-E25	2	60	35	87	50	20	20.04	6.52	10	127	164	245
	SF3520L-E20	3	60	35	97	60	20	22.04	6.52	12	115	149	223
SF7035L-E13	SF3515L-E20	2	70	35	67	40	40	20.47	4.77	16	91	117	176
	SF3515L-E25	2	70	35	77	50	40	22.47	4.77	20	83	107	160
	SF3515L-E20	3	70	35	87	60	40	24.47	4.77	24	76	98	147
SF7035L-E18	SF3520L-E25	2	70	35	77	40	30	20.04	6.52	12	127	164	245
	SF3520L-E20	2	70	35	87	50	30	22.04	6.52	15	115	149	223
	SF3520L-E25	3	70	35	97	60	30	24.04	6.52	18	106	136	204

※SF (Si-Fe), S(Sendust), H(High Flux) and customized designs are also available.